

# Granite Belt Retreat & Brewery

## Conferences & Functions 2025/2026

# ABOUT US

Located less than 10 minutes from the heart of Stanthorpe, Granite Belt Retreat & Brewery is situated on 30-acres of natural bushland.

An all-encompassing venue, we provide a relaxing environment for your next conference or function. If you have something in mind, we do our best to accommodate it – whether it be a multi-day seminar, training course, birthday, reunion or wake.

We can tailor packages to private groups with onsite accommodation for 60 guests. A range of catering options are available – and with the opportunity to sample craft beers at the bar, it makes for a unique location to host your next conference or event.

Continue reading to discover what we can offer, and please let us know if you have any questions.



PICTURED: A BIRDS EYE VIEW OF GRANITE BELT RETREAT & BREWERY

# OUR FACILITIES

## **Davadi Room**

The Davadi Room is a spacious, air-conditioned multipurpose function room – offering a log fireplace, conference equipment (a projector, screen & whiteboard) and complete privacy with separate amenities and outside courtyard.

It makes an ideal space for smaller groups, with a maximum room capacity of 45. Please note: depending on how you wish to set-up the room (for example – classroom or banquet style), room capacity may change.

Our Davadi Room is available for conferences and small functions.

## **Homestead Restaurant**

Featuring festoon lighting and a cosy country charm, our Homestead Restaurant is perfect for accommodating larger functions, with a maximum room capacity of 120.



PICTURED: HOMESTEAD RESTAURANT

# CONFERENCE ROOM HIRE

## **Davadi Room**

Half Day (8:30am to 12:30pm; 12:30pm to 4:30pm) – \$100

Full Day (8:30am to 4:30pm) – \$200

Room Hire includes:

- Whiteboard
- Data projector & screen
- Portable speaker with microphone
- Lectern
- Free wifi
- Tea & coffee station
- Room setup and packdown

## **Homestead Restaurant**

Our restaurant is open to the general public Friday to Monday. Exclusive use of our Homestead Restaurant is subject to our availability and group numbers; and a minimum spend applies for midweek use.



PICTURED: DAVADI ROOM

# CONFERENCE CATERING

## **Morning and/or Afternoon Tea**

\$15 per person

Choose one:

- House-made gourmet sweet biscuits & fresh seasonal fruit
- House-made cake & fresh seasonal fruit
- House-made muffins (sweet or savoury) & fresh seasonal fruit
- Cheese, dip and crackers & fresh seasonal fruit
- Antipasto platters

## **Lunch**

### **Takeaway Option**

\$25 per person

- Includes a piece of fruit or muffin and a 600ml water
- Choose from:
  - Thai Beef Salad
  - Chicken Caesar Salad
  - Salad Roll (Gourmet Leg Ham or Chicken & Avo)
  - Vegetarian/Vegan option available upon request

### **Build-your-own Baguette Station**

\$20 per person

- Selection of meats, salads, spreads and fresh bread

### **Seated Lunch**

- Main course only – individual meal prices, chosen from our current menu
- Main & dessert – \$40 per person, chosen from set menu
- Groups up to 29, individual preorder is required; groups 30 and above, an alternate drop menu is required

### **Dinner**

- 2-course option – \$54 per person; 3-course option – \$68 per person
- Groups up to 29, individual preorder is required; groups 30 and above, an alternate drop menu is required
- Please note: Minimum spend applies for midweek conferences

# FUNCTION CATERING

## **Grazing Stations (Lunch or Dinner)**

### Antipasto & Cheese

\$15 per person

- Selection of cheeses, cured meats, marinated vegetables, olives, house-made condiments & assorted crackers

### Hot Finger Food

\$20 per person

- Chef's selection of hot nibbles - for example: spring rolls, salt and pepper calamari, arancini balls, mixed savoury pastries, chicken wings

## **Seated Lunch**

- Main course only – individual meal prices, chosen from our current menu
- Main & Dessert – \$40 per person, chosen from set menu
- Groups up to 29, individual preorder is required; groups 30 and above, an alternate drop menu is required

## **Seated Dinner**

\$54 per person – 2-courses; \$68 per person – 3-courses

- Chosen from our current menu
- Groups up to 29, individual preorder is required; groups 30 and above, an alternate drop menu is required
- Please note: minimum spend applies for midweek functions

# ACCOMMODATION

Located on 30-acres of natural bushland, Granite Belt Retreat & Brewery can accommodate up to 60 guests.  
Our accommodation options include the following:

## **4 x Timber Suites**

Queen Bed + Single Bed (max. 3 guests)

## **8 x Timber Cabins**

Queen Bed + Single Bed (max. 3 guests)

## **2 x Spa Cabins**

Queen Bed (max. 2 guests)

## **6 x One Bedroom Family Cabins**

Queen Bed + Bunk Bed with trundle available (max. 5 guests)

## **Hidden House**

4 x Queen Bed + 1 x Bunk Bed (max. 10 guests)

A fully self-contained four bedroom and three bathroom house.



# TERMS & CONDITIONS

## **Confirmation and Final Payment**

Tentative bookings will be held for 14 days. The room hire fee is payable upon confirmation of your conference booking.

Confirmation of final numbers and final payment is required  
7 days prior to your function.

## **Payment Methods**

Direct bank transfers are preferred; please contact us for account details. We do accept MasterCard and VISA; however, please note credit card payments may attract a processing fee.

## **Conference/Function Requirements**

Menu requirements and associated function arrangements must be finalised no later than 14 days prior to the date of conference/function.

Dietary requirements can be catered for –  
if notified no later than 7 days prior to function.

## **Set-up & Decoration**

Basic room setup is included. If you wish to decorate, it is your responsibility to organise this and liaise with our staff to organise a suitable time to do so.

## **Cancellations & Postponements**

More than 3 months prior – your full deposit will be refunded,  
or transferred to a suitable date.

Within 3 months prior – your deposit will be forfeited.

Within 30 days prior – your deposit will be forfeited, and you will be charged 50% of your estimated function cost based on minimum numbers.

All cancellations and postponements must be notified in writing; and all postponements are subject to our availability.

# FLOOR PLAN

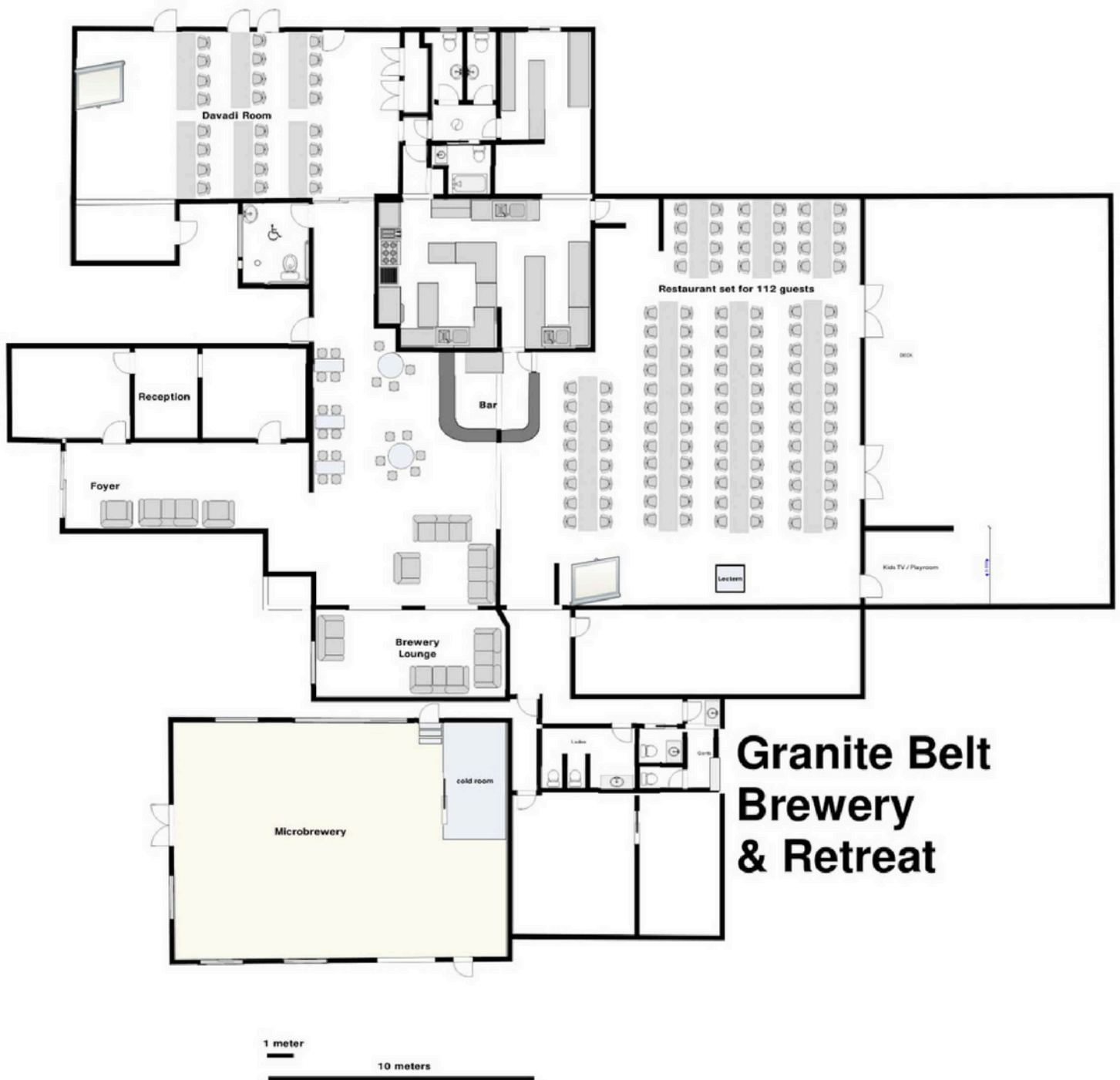

**Granite Belt  
Brewery  
& Retreat**



---

# CONTACT US

Please reach out if you have any questions,  
we'd love to hear from you!

**Email:** [reception@granitebeltretreat.com.au](mailto:reception@granitebeltretreat.com.au)

**Call:** (07) 4681 1370